

Local Planning Panel

11 December 2019

55 Pitt Street, Redfern

D/2019/843

Applicant: Solgen Energy PTY LTD

Owner: City of Sydney

proposal

installation of photovoltaic solar panels and associated structures to the roof of the centre-based childcare facility known as 'Redfern Occasional Childcare'

the site is in the SP2 – Infrastructure Zone, consistent with 'community purpose' and is permissible.

recommendation

approve subject to conditions

notification information

- exhibition period 9 August 2019 to 29 August 2019
- 306 owners and occupiers notified
- no submissions were received

site

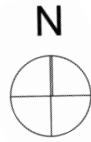



site viewed from Pitt Street



site from Burnett Street

proposal

ITEM	SPECIFICATION	QTY
MODULE	TRINA SOLAR 330W	100
OPTIMIZER	P700	50
INVERTER	SOLAREEDGE 27,6K	1
TOTAL		33kWp

ITEM	UNIT	QTY
ANCHOR POINT	EACH	0
STATIC LINE	PER METER	0
HAND RAIL	PER METER	0
LADDER HOOK	EACH	1

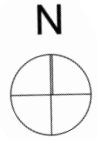
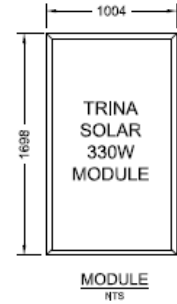
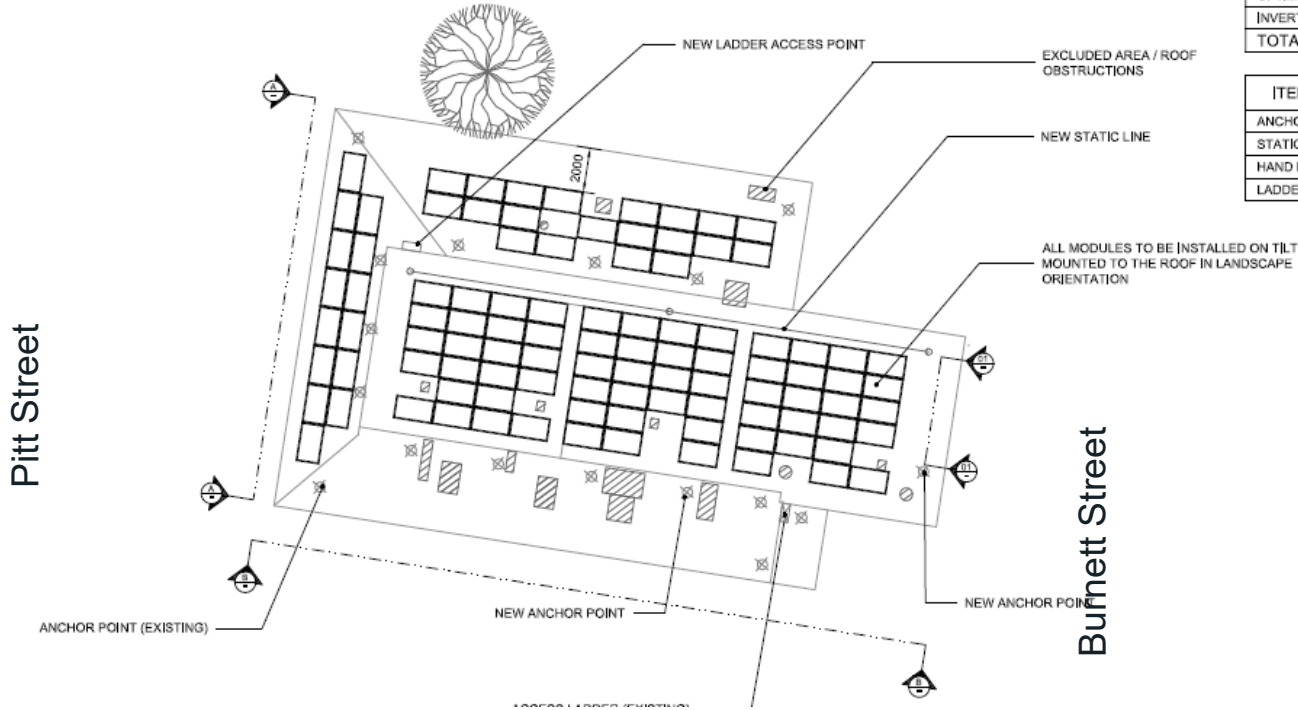

roof plan

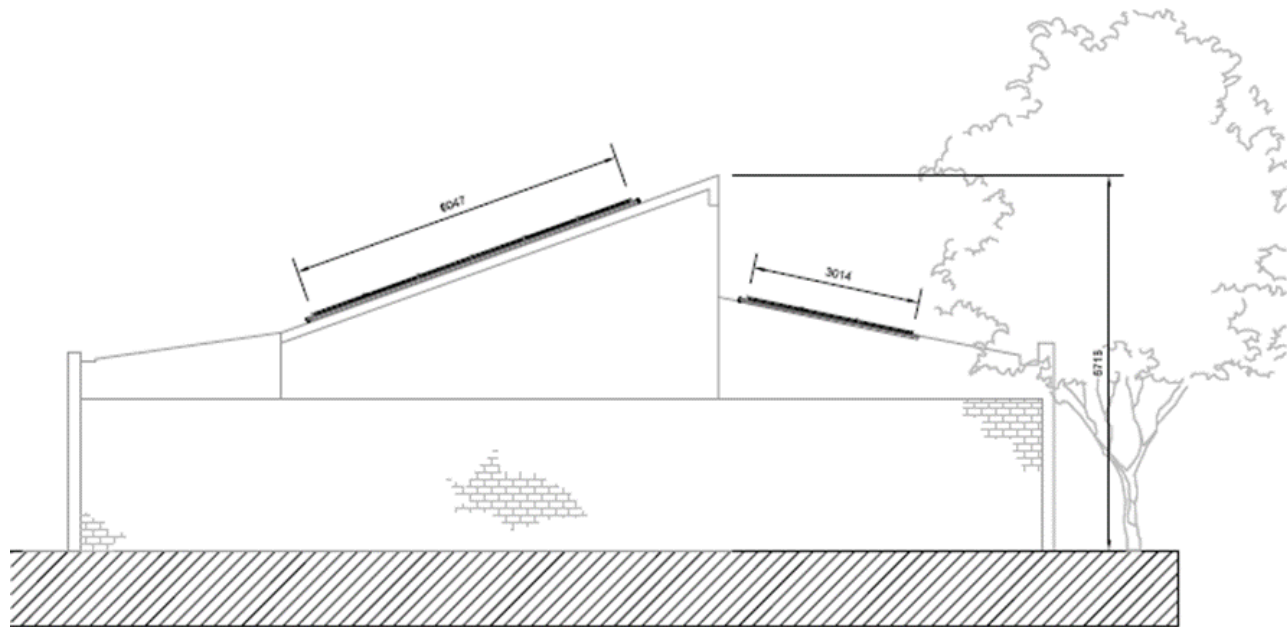

EAST ELEVATION C-C
SCALE 1:100

east elevation (Burnett Street)

compliance – SEPP (infrastructure) 2007

	control	proposed	compliance
maximum capacity	100kW	33kW	complies

compliance - key LEP development standards

	control	proposed	compliance
height	12m	6.7m	complies
floor space ratio	1.25:1	NA	NA

Issues – heritage/design

- site is a detracting building within the Redfern Estate Heritage Conservation Area
- limited visibility of solar installation from the street
- oblique angled view from balconies of residential apartments along Burnett Street
- will not detract from the heritage conservation area or nearby heritage items
- no adverse amenity impacts

recommendation

- approval subject to conditions